

AIR TORQUE

AIR TORQUE S.p.A.

via Alla Campagna, N°1
24060 Costa di Mezzate(Bg) Italy
Tel.: +39 035 682299
Fax: +39 035 687791
E-mail: info@airtorque.it

Technical Data Sheet n° **PT045DU**
Issued on: 06/06

Page: 1/1

Model PT045
DA and SR - 90°

Dimensions - in inch

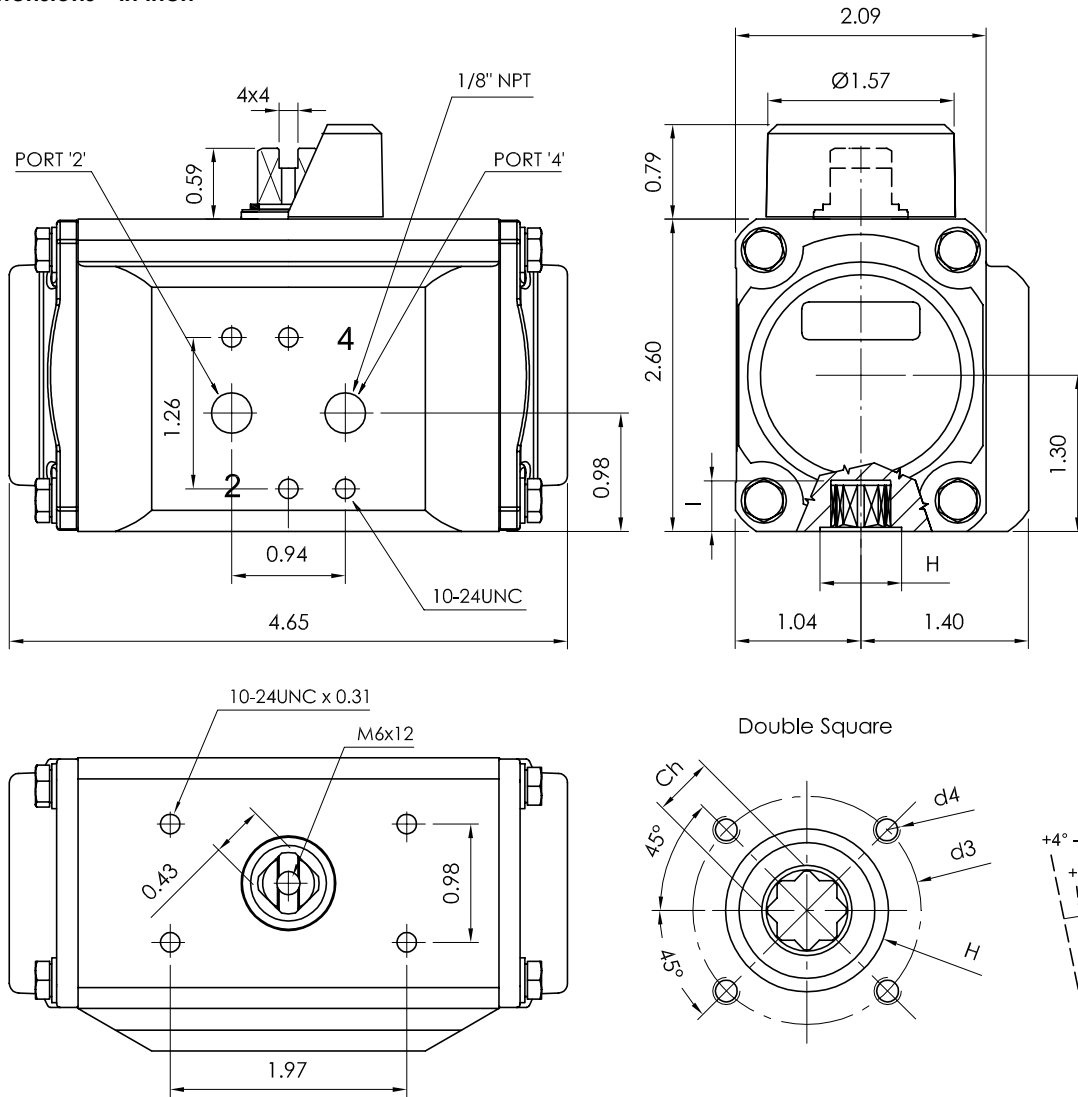

Available flange:

- ⇒ F03
- ⇒ F04

Flange Dimensions		
ISO 5211	F03	F04
d2 f8	NA	1,18
d3	1,42	1,65
d4	10-24UNC x0,31	10-24UNC x0,31
H	NA	1,18
Ch	0,35	0,43
l min.	0,39	0,47
h min.	0,02	0,02
h1	NA	0,06
Pressure connection	N 1	
Ancillary Attachment	AA 0	

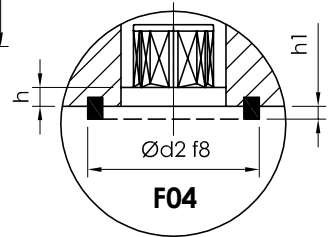

Spigot available only on request

ROTATION

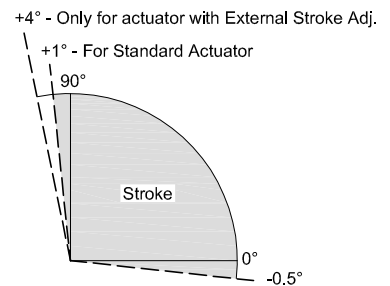

TYPE	OUTPUT TORQUE FOR DOUBLE ACTING IN LB-IN								WEIGHT (LBS)								
	40 Psi		50 Psi		60 Psi		70 Psi		80 Psi		90 Psi		100 Psi		116 Psi		
Pressure	0°	90°	0°	90°	0°	90°	0°	90°	0°	90°	0°	90°	0°	90°	0°	90°	1,65
D	58,3		72,9		87,4		102		117		131		146		169		

TYPE	OUTPUT TORQUE FOR SPRING RETURN IN LB-IN														Spring stroke		WEIGHT (LBS)			
	40 Psi		50 Psi		60 Psi		70 Psi		80 Psi		90 Psi		100 Psi		116 Psi			90°	0°	
Pressure	0°	90°	0°	90°	0°	90°	0°	90°	0°	90°	0°	90°	0°	90°	0°	90°	0°	90°	Start	End
S 2-2			41,9	16,2	56,5	30,8	71,0	45,4	85,6	59,9	100	74,5	115	89,1	138	112	56,6	31,0	1,94	
S 2-3					50,3	16,6	68,4	31,2	79,4	45,8	94,0	60,3	109	74,9	132	98,2	70,8	37,2	1,96	
S 3-3							57,8	17,0	72,3	31,6	86,9	46,2	101	60,8	125	84,1	85,0	44,3	1,98	

Max. Pressure	Rotation (A)	Screw stroke Adj. (OPTIONAL) (A)	Chamber φ (inch)	Air Volume (in3) Opening	Air Volume (in3) Closing	Moving Time (Sec.) (B)		Operating Temperature (°F) (C)				
						D	S	STD (standard)	HT (high temperature)	LT (low temperature)		
116 Psi	90° (-0,5° / +1°)	AVAILABLE ONLY ON REQUEST IN FULLY OPEN POSITION	1,77	3,66	6,10	D	0,15	D	0,20	NBR "O" ring	FPM "O" ring	Silicone "O" ring
						S	0,20	S	0,25	-4 to + 176	+ 5 to + 300	- 40 to + 176

- Note:**
- (A) Rotation for STANDARD actuator: 91.5°, +1° in open position (CCW for STANDARD) and -0.5° in close position (CW for STANDARD),
Rotation for actuator with EXTERNAL STROKE ADJUSTMENT: 94.5°, 90° +4° adjustable in open position (CCW for STANDARD) and -0.5° in close position (CW for STANDARD),
 - (B) The above indicated moving time of the actuator, are obtained in the following test conditions:
(1) Room Temperature, (2) Actuator Stroke 90°, (3) Solenoid Valve with Orifice Of 4 mm and a flow capacity Qn 400 L/min., (4) Inside pipe diameter 8 mm, (5) Medium clean air, (6) Air supply pressure 5,5 bar (79,75 Psi), (7) Actuator without external resistance load.
 - Cautions: obviously on the field applications when one or more of the above parameter are different, the moving time will be different.**
 - (C) For HT (high temperature) and LT (low temperature) services, a special Lubricant is requested. Please contact Air Torque factory.

Operating Medium:

The operating medium must be free of dust and oil. The maximum particle size must not exceed 30µm (ISO 8573 Part1, Class5). In order to prevent water condensation and/or solidification (ice, when actuator work below 0°C), the operating medium must have a dew point equal to -20°C or, at least 10°C below the ambient temperature (ISO 8573 Part1, Class3).